

Stockwell Avenue

Sadler Forester Way

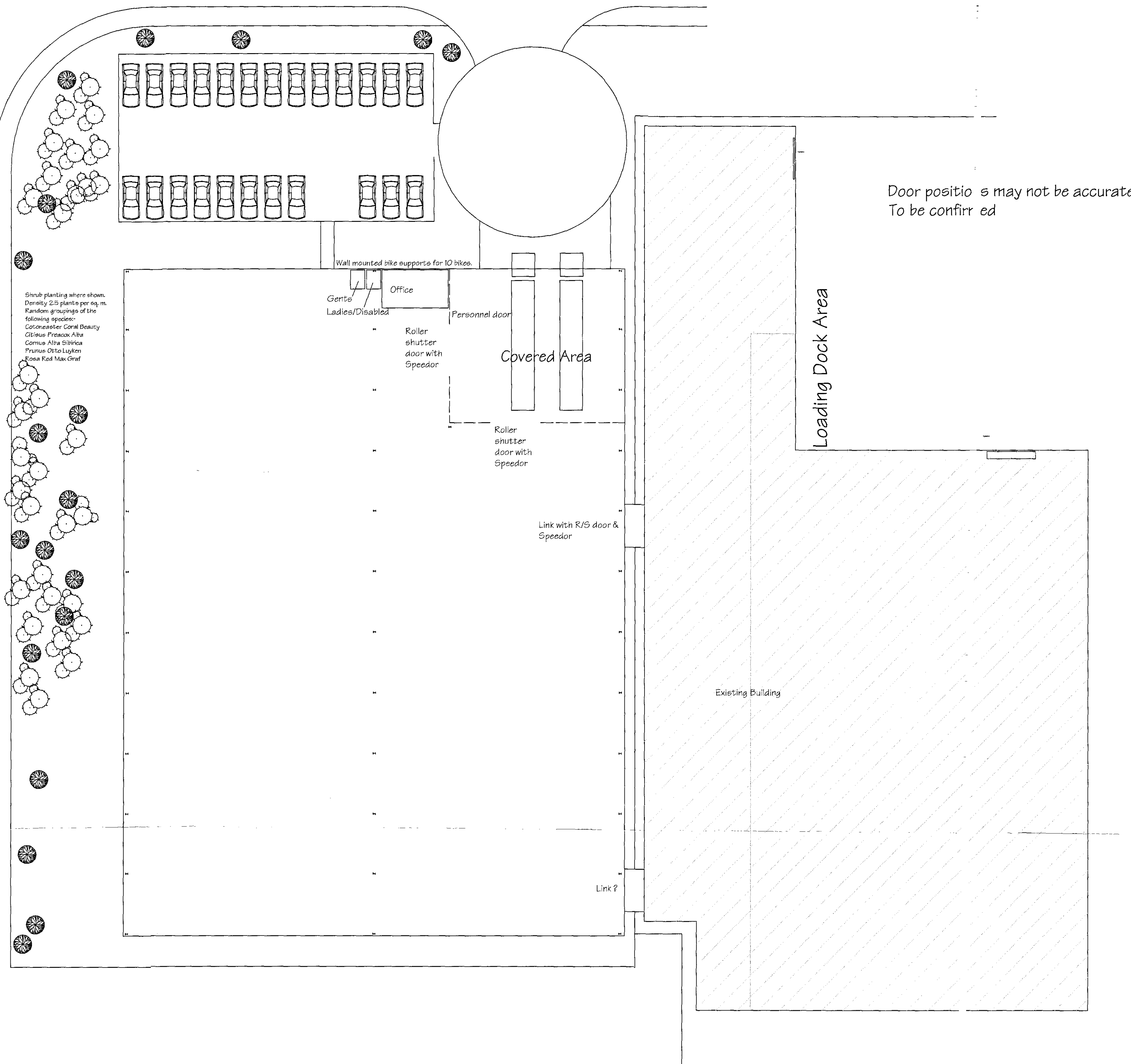

05/1561/

STOCKTON BOROUGH COUNCIL
 DEPOSITED PLAN
 12 JUL 2005
 SUPERCEDES PLAN DATED
 HEAD OF PLANNING & ENV.

Rev C - 7:7:05 - Bike racks added.
 Rev B - 08:12:04 - Building reduced in width to 53m
 Rev A - 19:04:04 - Cols moved to centre of the building.

ARRAN

TITLE Site Plan	
CLIENT RTA Ltd	PROJECT
SCALE 1:250	DATE 10:02:04
	Drawn RTA1 rev C